

**PCB Sockets
PCB Mount, 2.0mm Pitch**

Product Specification:

Materials and Finish

Insulator: Glass-reinforce thermoplastic, UL-94V-0 rated, color-black, resist to short term temperature in infra-red reflow phase - 260°C for 20 seconds. (See page 9 "Reflow Conditions" for detailed information)

Contact: Phosphor Bronze per QQ-B-750, plated full flash gold, full 100µ" tin/lead or selected gold in mating area; 100µ" min. tin-lead on termination area, with entire contact under-plated 50µ" min. nickel

Electrical

Contact Resistance: 30 milliohms max. at 1 ampere DC

Insulation Resistance: 1000 megohms at 500 VDC

Dielectric Withstanding Voltage: 500 VAC/rms 60Hz for one minute

Current Rating: 1 ampere per contact

Voltage Rating: 250 VAC/rms 60Hz

Mechanical

Insertion Force: 150 grams maximum per contact

Withdrawal Force: 50 grams minimum per contact

Contact Retention: 2.0 kgs minimum per contact

Durability: See page 9

Related Product Data

PC Board Layout: See page 77

Ordering Information:

G827 XX X X X X X X

**PCB Sockets
PCB Mount
2.0mm Pitch**

Number of Positions

Single Row: 04 to 40 positions
Dual Rows: 06 to 80 positions

Mounting Style

1: Single row
2: Dual rows

Connector Style

0: Straight type
1: Right angle type

Contact Finish

0: Full flash gold
1: Flash gold
2: 10µ" gold
3: 30µ" gold
4: Tin

Height of Insulator

0: 4.0 mm (for dual row only)
1: 4.3 mm

Length of PC Tail

0: 1.2 mm
1: 2.4 mm (standard)
2: 3.2 mm

Variation Code

Blank: Standard

PCB Sockets
PCB Mount, Single Row, 2.0mm Pitch

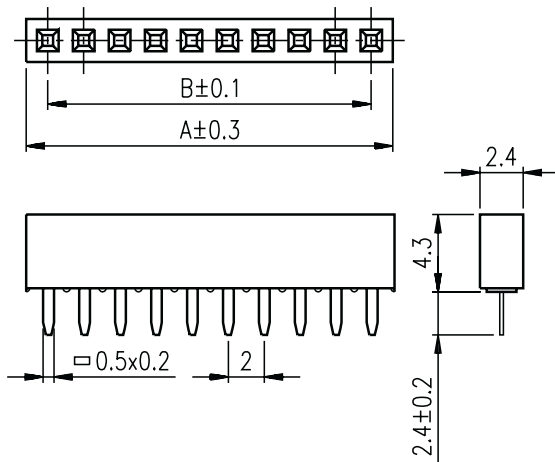

Straight PCB Mount

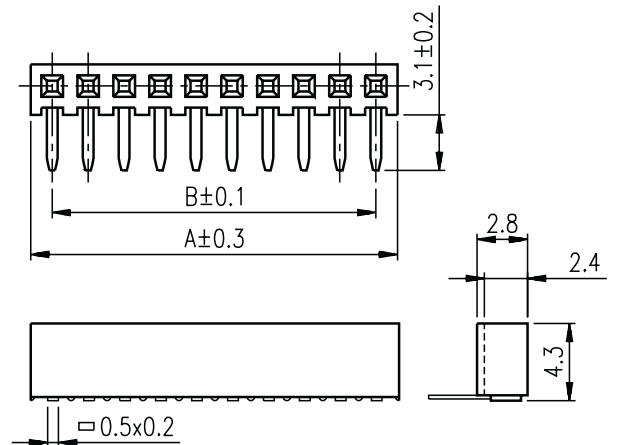

Right Angle PCB Mount

No. of Positions	Dimensions (mm)		No. of Positions	Dimensions (mm)		No. of Positions	Dimensions (mm)	
	A	B		A	B		A	B
4	8.5	6	17	34.5	32	30	60.5	58
5	10.5	8	18	36.5	34	31	62.5	60
6	12.5	10	19	38.5	36	32	64.5	62
7	14.5	12	20	40.5	38	33	66.5	64
8	16.5	14	21	42.5	40	34	68.5	66
9	18.5	16	22	44.5	42	35	70.5	68
10	20.5	18	23	46.5	44	36	72.5	70
11	22.5	20	24	48.5	46	37	74.5	72
12	24.5	22	25	50.5	48	38	76.5	74
13	26.5	24	26	52.5	50	39	78.5	76
14	28.5	26	27	54.5	52	40	80.5	78
15	30.5	28	28	56.5	54			
16	32.5	30	29	58.5	56			

PCB Sockets
PCB Mount, Dual Rows, 2.0mm Pitch

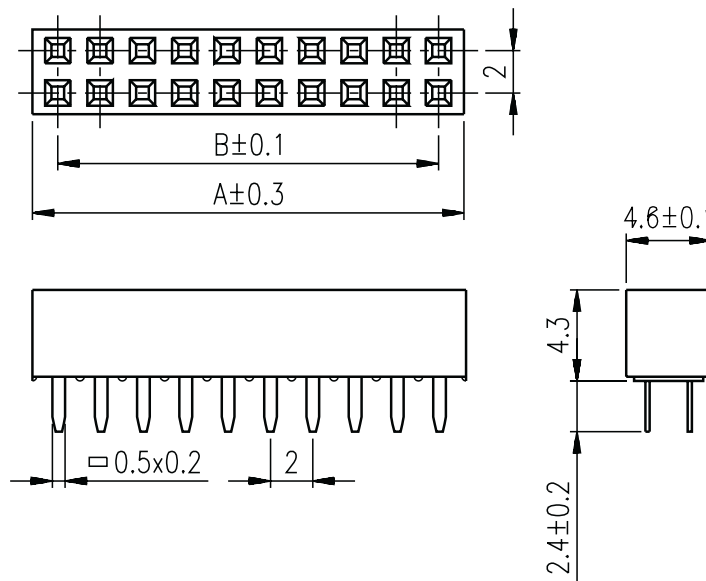
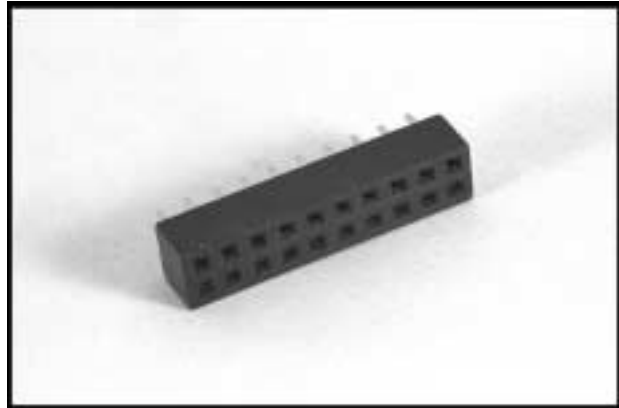

No. of Positions	Dimensions (mm)		No. of Positions	Dimensions (mm)		No. of Positions	Dimensions (mm)	
	A	B		A	B		A	B
6	6.5	4	32	32.5	30	58	58.5	56
8	8.5	6	34	34.5	32	60	60.5	58
10	10.5	8	36	36.5	34	62	62.5	60
12	12.5	10	38	38.5	36	64	64.5	62
14	14.5	12	40	40.5	38	66	66.5	64
16	16.5	14	42	42.5	40	68	68.5	66
18	18.5	16	44	44.5	42	70	70.5	68
20	20.5	18	46	46.5	44	72	72.5	70
22	22.5	20	48	48.5	46	74	74.5	72
24	24.5	22	50	50.5	48	76	76.5	74
26	26.5	24	52	52.5	50	78	78.5	76
28	28.5	26	54	54.5	52	80	80.5	78
30	30.5	28	56	56.5	54			

Recommended PCB Layouts
PCB Sockets, 2.0mm Pitch

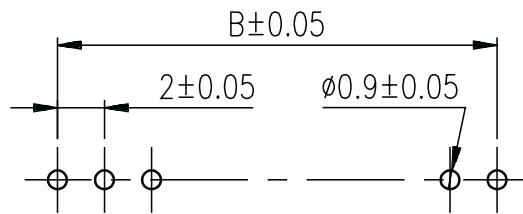

Recommended PCB Layout
(Single Row)

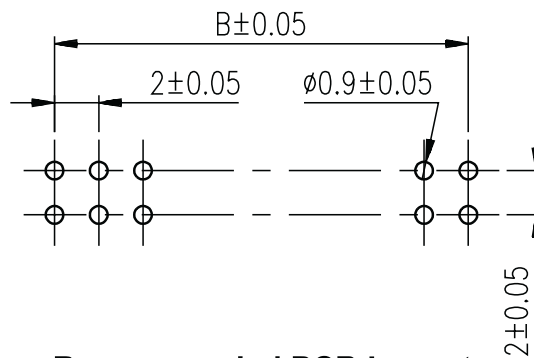

Recommended PCB Layout
(Dual Rows)